



Maguire Properties

Overview

Maguire



Maguire Properties, Inc., a publicly-traded real estate investment trust, is one of the largest owners, developers and managers of first-class office properties in Southern California with an important presence in key markets such as Downtown Los Angeles, the Tri-Cities, Santa Monica, the Irvine Airport and Anaheim Stadium areas in Orange County and Sorrento Mesa in San Diego County.

The Company has substantial in-house expertise and resources in finance, development, marketing, leasing and property management and is firmly established as the largest commercial real estate owner and developer in the Downtown LA central business district with 9.1 million feet of Class 'A' space in 8 trophy quality towers.

Maguire Properties is well known for its successful track record of developing landmark, large-scale developments of lasting quality and architectural excellence. The Company's impressive portfolio reinforces the Company's core strategy to own, manage, acquire and develop buildings of exceptional quality that provide attractive and productive environments for tenants and their employees and improve the cities and communities in which they are located.





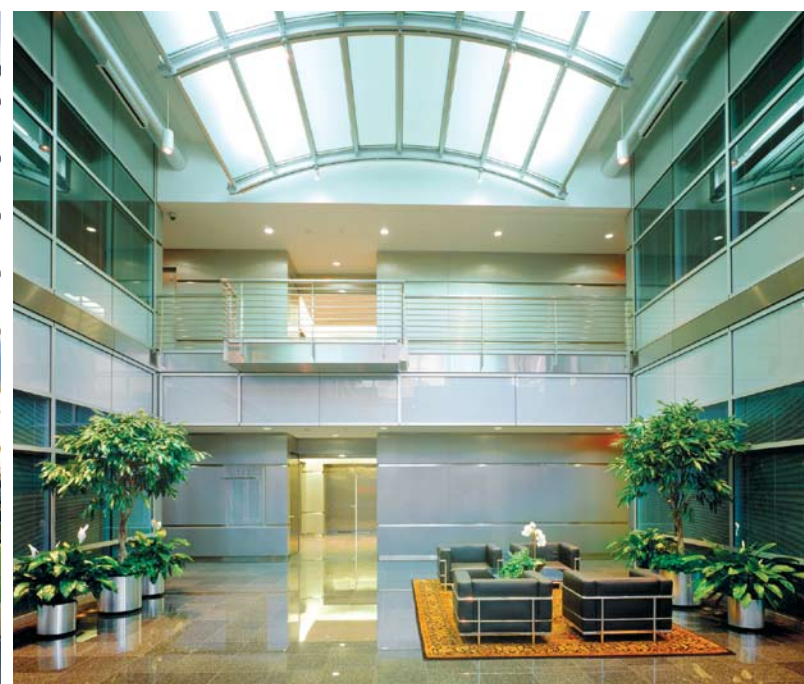



SANTA MONICA



SAN DIEGO



BREA

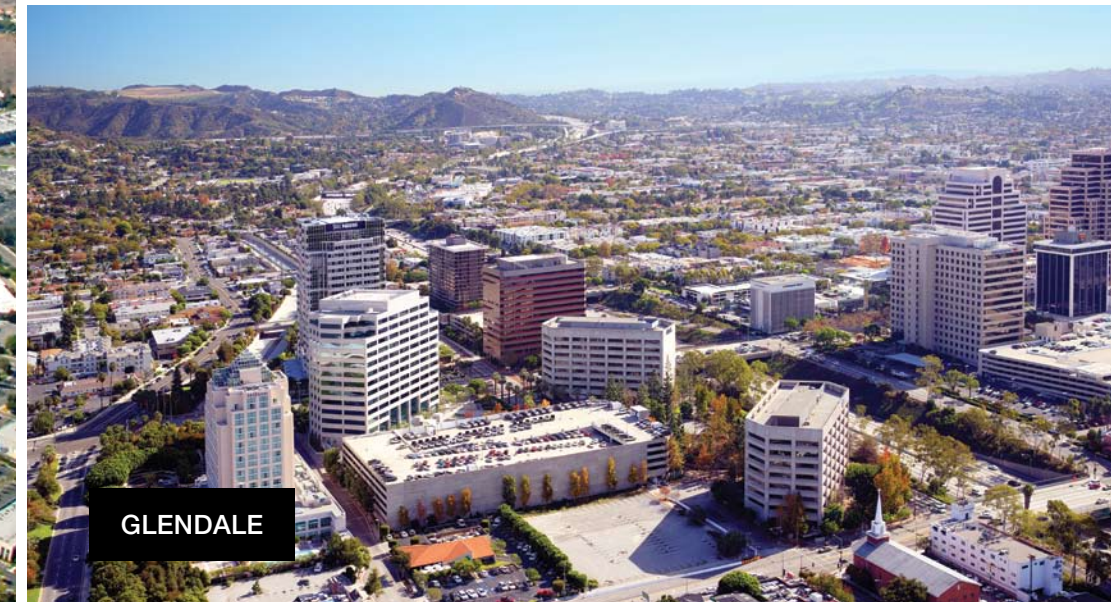

GLENDALE



COSTA MESA



CENTRAL ORANGE COUNTY







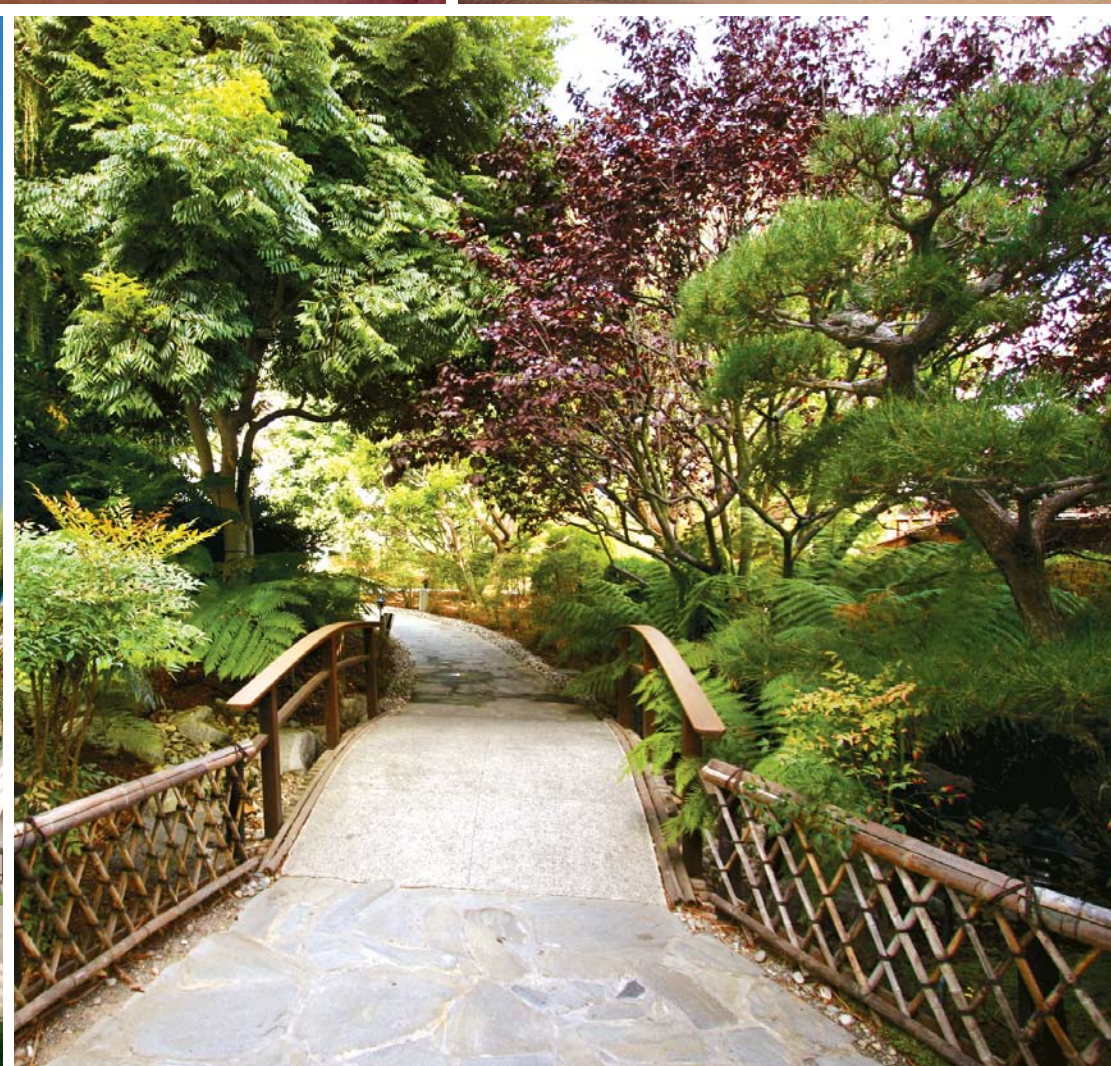



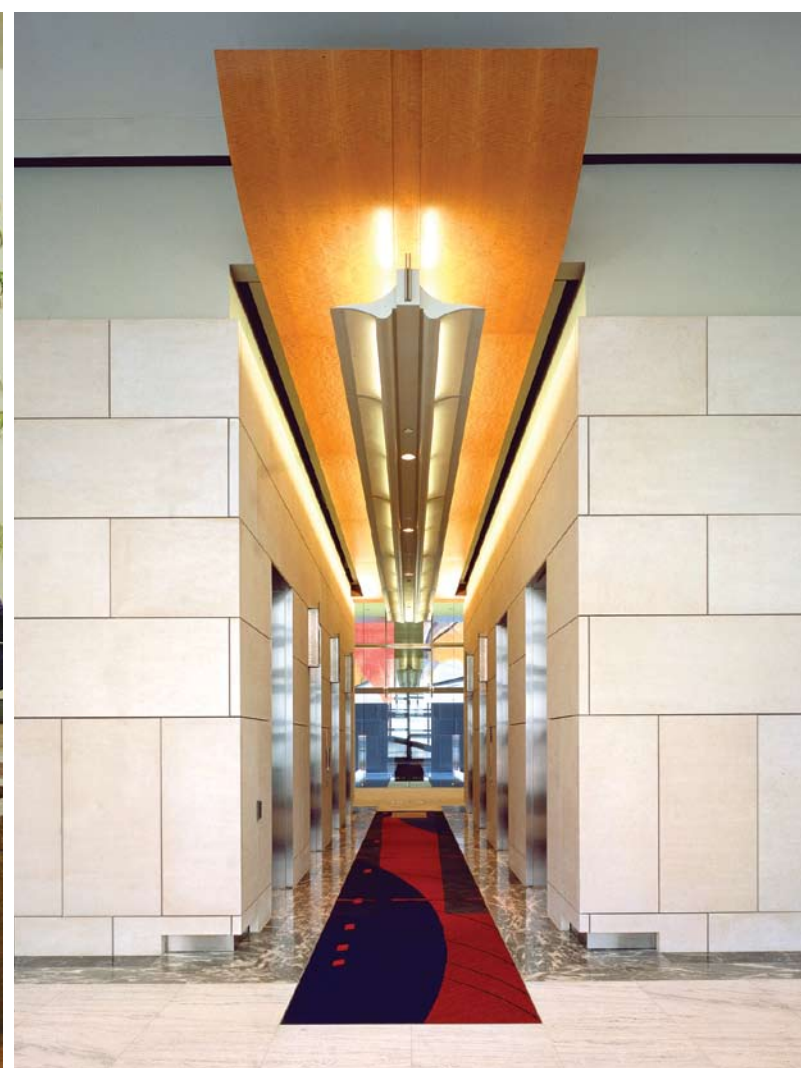



“Thus in these ways we will transmit this City, not only not less, but greater and more beautiful than it was transmitted to us.”

— ATHENIAN OATH OF CITIZENSHIP
Oath taken over 2,000 years ago by the Citizens of Athens



Maguire

355 South Grand Avenue
Suite 3300
Los Angeles, California 90071
213 626 3300 Tel
213 687 4758 Fax

To request hard copies of this brochure please contact:

Bill Flaherty
213 613 4466 Tel
bill.flaherty@maguireproperties.com

www.maguireproperties.com